

Presidential Series



The front of the home may be reversed from this picture.

The McKinley is perfect for growing families and one of our most popular floor plans. From the spacious two-story foyer you will appreciate how open this floor plan is, with the dining room and living room off of the foyer. The great room opens to the morning room and kitchen. You'll also find a popular master suite with cathedral ceiling, walk-in closet, and garden tub on the first floor offering the privacy you always dreamed of. Upstairs is a loft overlooking the great room.

The McKinley "D" 3279 Sq. Ft.

*4-Bedroom, 3 1/2-Bath,
2-Story, Living Room,
Dining Room, Morning
Room, Laundry Room,
Loft*



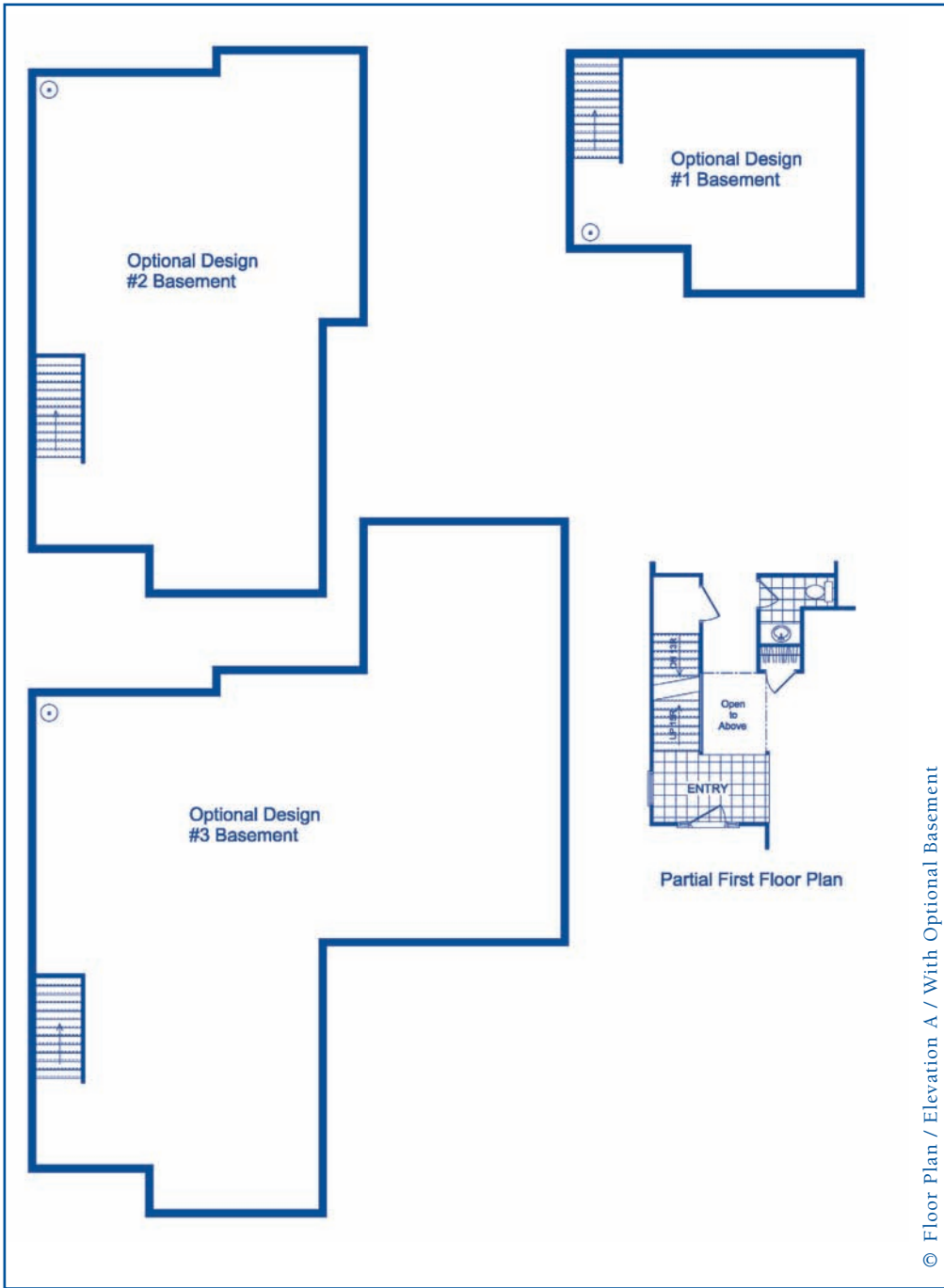

© Floor Plan / Elevation A / With Optional Basement

Community

Homesite #

Customer

PRINTED

SIGNATURE/DATE

Co-customer

PRINTED

SIGNATURE/DATE

SPECIAL NOTES:

(Check One)

- Std. Concrete Slab _____ Opt. Crawl _____
- Opt. Bsmt #1 _____ Opt. Bsmt #2 _____
- Opt. Bsmt #3 _____

CUSTOMER SELECTED CHANGES AND OPTIONS

The McKinley "D"

4-Bedroom, 3 1/2-Bath, 2-Story, Living Room, Dining Room, Morning Room, Laundry Room, Loft

BASEMENT PLAN

Optional Design #1 Basement = 550 sq. ft.
(Includes three porcelain lights and two 4x10 heat registers)

Optional Design #2 Basement = 1332 sq. ft.
(Includes five porcelain lights and three 4x10 heat registers)

Optional Design #3 Basement = 2030 sq. ft.
(Includes seven porcelain lights and four 4x10 heat registers)

Ask about our guaranteed existing home buyout program!



*Trademark of The Dow Chemical Company

Copyright 2007. Paul Shoopman Home Building Group. The floor plan or optional basement brochure shown above is a conceptual floor plan which also has dotted lines showing potential extensions of the home. If these specific extension options are selected they will be added to the base price of the home listed on the HCI. The dotted lines are not a part of the base house price and is an additional charge. The elevation rendering is also a conceptual view of the home. Prices, plans, dimensions and specifications are subject to change without notice.