

shoopmanhomes.com

Shoopman
Homes

1-877-474-6676

SANCTUARY AT 121ST



Bentley
Model open 7 days a week
Call today for your showing

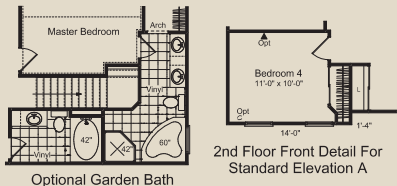

2nd Floor Front Detail For Standard Elevation A

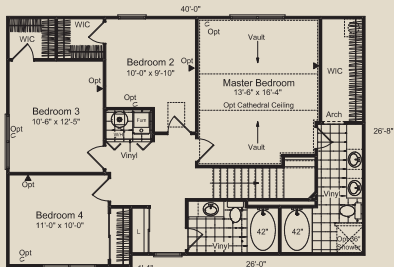

2nd Floor

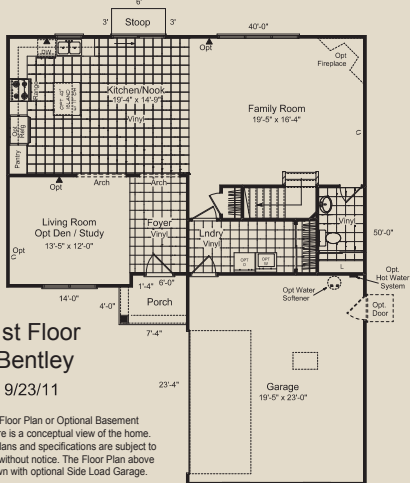

1st Floor Bentley

9/23/11

The Floor Plan or Optional Basement Brochure is a conceptual view of the home. Prices, plans and specifications are subject to change without notice. The Floor Plan above is shown with optional Side Load Garage.

For a larger view of this floorplan visit shoopmanhomes.com

- 7,000 Sq. Ft. New Home Show Room
- Free Mortgage Qualifier
- Free Credit Check
- So Long Landlord
- Tired of Renting?



Minimum Combined Family Income Needed (before taxes) for THIS Home

Minimum Household Annual	Minimum Household Monthly	Minimum Household Weekly	Minimum Two Hourly Working Household Income
\$48,000	\$4,000	\$1,000.00	\$16.20 \$16.20

*All Paul Shoopman Home Building Group offers, prices and sales promotions are subject to specific rules, restrictions, time periods and limited quantities; and may be changed or withdrawn without notice at any time. Ask sales consultant for details. Offer expires February 29, 2012. All referrals must be in writing and dated. They must be received prior to the date that the referred buyer contacts Paul Shoopman Home Building Group on their own, or are referred by another source. This program cannot be combined with any other program and is not retroactive. This program is subject to change and may be withdrawn at any time. Only applicable with full price offer. *Payments estimated on a FHA 30 year Fixed rate at 3.875% Principal and interest only. 4.62% APR with a 3.5% down payment. Calculations based on sale price of \$216,900.

SANCTUARY AT 121ST

- A world of its own, Sanctuary is a pristine, breathtaking neighborhood nestled carefully in the quaint community of Zionsville on 121st St. just east of Michigan Rd. The Sanctuary was created as a place of refuge, preservation and nourishment. Not just for wildlife and trees, but for those who want to nourish unique relationships with neighbors and family.
- The Sanctuary at 121st Street offers low maintenance living custom oversized homes priced from the \$300's just perfect for the "empty nester".
- This neighborhood is close to I-465 and convenient to shopping at Clay Terrace, Keystone at the Crossing, and downtown Zionsville with it's nostalgic brick streets. Nearby parks include Coxhall Gardens and West Park.

* All Shoopman Homes have a 2-10 Home Buyer's Warranty.

*Indianapolis' #1 referral program.

Sanctuary at 121st:
12075 Sanctuary Blvd.
Zionsville, IN 46077
Phone/Fax: 317-733-8480
1-877-4-Shoopman
(1-877-474-6676)



*Payments estimated on a FHA 30 year Fixed rate at 3.875%
Principal and interest only. 4.62% APR with a 3.5% down payment.

Save as You Go Program available.



- Brand New 7,000 sq. ft. Paul Shoopman (New Home) Showroom.
- You will be amazed at the top-of-line design and features of this gorgeous showroom.
- Industry-leading facility - that features hundreds of design options and upgrades for your home.



**newhome
showroom**

Located at 121st St. and Shelborne Rd.
12070 Abney Run Dr.
Zionsville, IN 46077
1-877-4-SHOOPMAN (1-877-474-6676)



- This unique Showroom Experience is one-of-a-kind and is now open to the Public.
- Browsing Hours are available 7 Days A Week
Mon. - Wed. 8-5 pm Saturday 8-5 pm
Thurs. - Fri. 8-7 pm Sunday 12-5 pm



We're only a click away on Mapquest



12070 Abney Run Dr.
Zionsville, IN 46077