

shoopmanhomes.com



1-877-474-6676

Maple Knoll

Log on
for a Virtual Tour
www.shoopmanhomes.com

Why Rent?

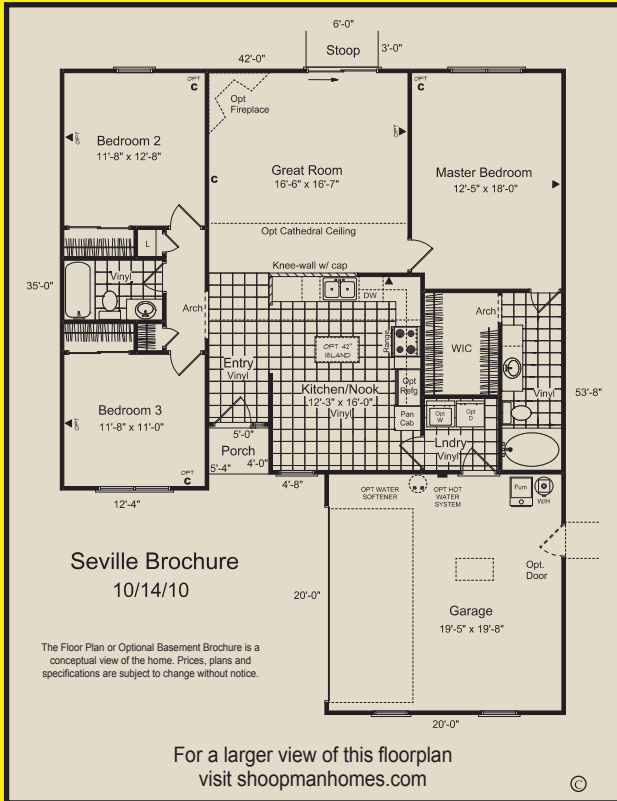

- 7,000 Sq. Ft.
- New Home Show Room
- Free Mortgage Qualifier
- Free Credit Check
- So Long Landlord
- Tired of Renting?

Ask about our
40-10
Program

\$774*
Monthly Payments



Seville
Model open 7 days a week
Call today for your showing

Minimum Combined Family Income Needed (before taxes) for THIS Home

Minimum Household Annual	Minimum Household Monthly	Minimum Household Weekly	Minimum Two Hourly Working Household Income
\$39,672	\$3,306	\$763.00	\$9.54 \$9.54

*All Paul Shoopman Home Building Group offers, prices and sales promotions are subject to specific rules, restrictions, time periods and limited quantities; and may be changed or withdrawn without notice at any time. Ask sales consultant for details. Offer expires February 29, 2012. All referrals must be in writing and dated. They must be received prior to the date that the referred buyer contacts Paul Shoopman Home Building Group on their own, or are referred by another source. This program cannot be combined with any other program and is not retroactive. This program is subject to change and may be withdrawn at any time. Only applicable with full price offer. *Payments estimated on a FHA 30 year Fixed rate at 3.875% Principal and interest only. 4.62% APR with a 3.5% down payment. Calculations based on sale price of \$168,900.

Maple Knoll

- Features upscale single family homes from our Classic Series. Homes start from the \$160's to \$300's. We have walk-out and daylight basement homesites available with generous size yards.
- Located on West side of Springmill Rd., North of 161st St. in Westfield, within the highly desired Westfield School district.
- Enjoy our walking trails, swimming pool, playground and tennis courts. Experience the nearby shopping, dining, and entertainment at Clay Terrace and the Springmill Commons Shopping Center of Westfield.

* All Shoopman Homes have a Diamond 2-10 Home Buyer's Warranty.

*Indianapolis' #1 referral program.

Maple Knoll:
429 Redhill Rd.
Westfield, IN 46074
Phone/Fax: 317-896-5544
1-877-4-Shoopman
(1-877-474-6676)

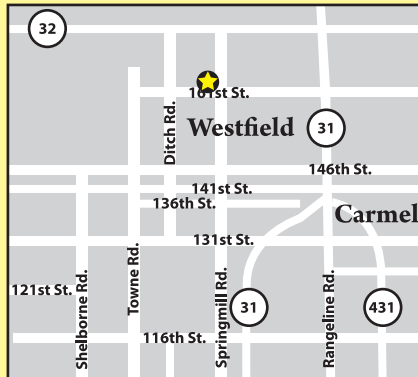

*Payments estimated on a FHA 30 year Fixed rate at 3.875%
Principal and interest only. 4.62% APR with a 3.5% down payment.

Save as You Go Program available.



- Brand New 7,000 sq. ft. Paul Shoopman (New Home) Showroom.
- You will be amazed at the top-of-line design and features of this gorgeous showroom.
- Industry-leading facility - that features hundreds of design options and upgrades for your home.



newhome
showroom

Located at 121st St. and Shelborne Rd.
12070 Abney Run Dr.
Zionsville, IN 46077
1-877-4-SHOOPMAN (1-877-474-6676)



- This unique Showroom Experience is one-of-a-kind and is now open to the Public.
- Browsing Hours are available 7 Days A Week
Mon. - Wed. 8-5 pm Saturday 8-5 pm
Thurs. - Fri. 8-7 pm Sunday 12-5 pm



We're only a click away on Mapquest



shoopmanhomes.com
Shoopman
Homes
1-877-474-6676

12070 Abney Run Dr.
Zionsville, IN 46077