

shoopmanhomes.com



1-877-474-6676

# JEFFERSON PARK



Log on  
for a Virtual Tour  
www.shoopmanhomes.com

- 7,000 Sq. Ft.
- New Home Show Room
- Free Mortgage Qualifier
- Free Credit Check
- So Long Landlord
- Tired of Renting?



**Seville**  
Model open 7 days a week  
Call today for your showing

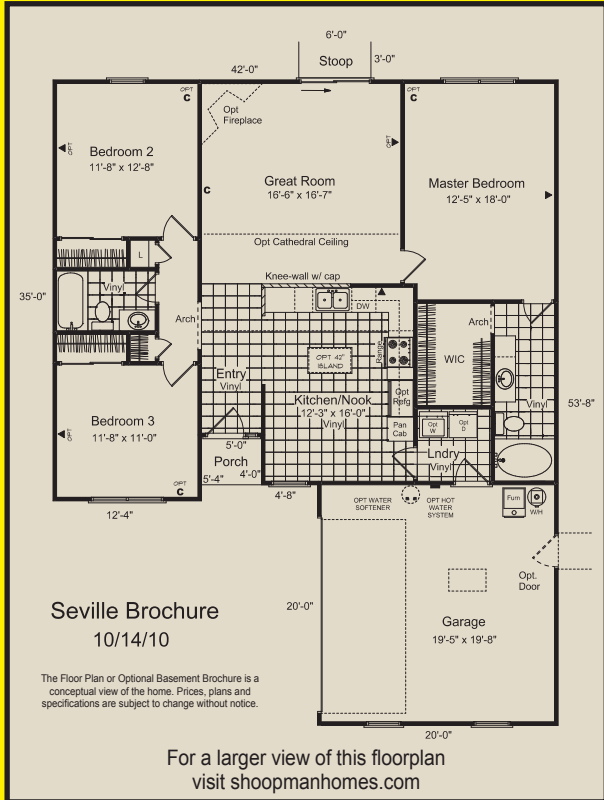

Minimum Combined Family Income Needed (before taxes) for THIS Payment				
Minimum Household Annual	Minimum Household Monthly	Minimum Household Weekly	Minimum Two Hourly Working Household Income	
<b>\$35,400</b>	<b>\$2,950</b>	<b>\$680.76</b>	<b>\$8.49</b>	<b>\$8.49</b>

\*All Paul Shoopman Home Building Group offers, prices and sales promotions are subject to specific rules, restrictions, time periods and limited quantities; and may be changed or withdrawn without notice at any time. Ask sales consultant for details. Offer expires February 29, 2012. All referrals must be in writing and dated. They must be received prior to the date that the referred buyer contacts Paul Shoopman Home Building Group on their own, or are referred by another source. This program cannot be combined with any other program and is not retroactive. This program is subject to change and may be withdrawn at any time. Only applicable with full price offer. \*Payments estimated on a FHA 30 year Fixed rate at 3.875% Principal and interest only. 4.62% APR with a 3.5% down payment. Calculations based on sale price of \$139,900.

# JEFFERSON PARK

- Jefferson Park features single family ranch and two-story homes that are perfect for families, couples or singles just starting out. Our Classic Series of homes are the centerpiece of this neighborhood and offer buyers elegant architecture and interior designs all at an affordable price.
- This beautiful "family-friendly" community is convenient to shopping and dining, convenient to I-465 & I-74 and an easy commute to Downtown and the Indianapolis Motor Speedway.
- Located on Burlington Parkway, South of East Main Street in beautiful Pittsboro, Indiana. Jefferson Park has it all, tree lined streets, wood bordered home sites and a picturesque pond. Everything you would want wrapped up in one convenient and highly desirable location.

\* All Shoopman Homes have a Diamond 2-10 Home Buyer's Warranty.

\*Indianapolis' #1 referral program.

Jefferson Park:  
Phone/Fax: 317-209-9639  
1-877-4-Shoopman  
(1-877-474-6676)



\*Payments estimated on a FHA 30 year Fixed rate at 3.875%  
Principal and interest only. 4.62% APR with a 3.5% down payment.

Save as You Go Program available.



- Brand New 7,000 sq. ft. Paul Shoopman (New Home) Showroom.
- You will be amazed at the top-of-line design and features of this gorgeous showroom.
- Industry-leading facility - that features hundreds of design options and upgrades for your home.



**new home**  
**showroom**

Located at 121st St. and Shelborne Rd.  
12070 Abney Run Dr.  
Zionsville, IN 46077  
1-877-4-SHOOPMAN (1-877-474-6676)

- This unique Showroom Experience is one-of-a-kind and is now open to the Public.
- Browsing Hours are available 7 Days A Week  
Mon. - Wed. 8-5 pm      Saturday 8-5 pm  
Thurs. - Fri. 8-7 pm      Sunday 12-5 pm

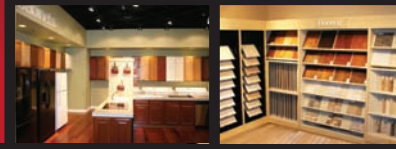

12070 Abney Run Dr.  
Zionsville, IN 46077