



Log on
 for a Virtual Tour
www.shoopmanhomes.com



Kingston
 Model open 7 days a week
 Call today for your showing

- 7,000 Sq. Ft.
- New Home Show Room
- Free Mortgage Qualifier
- Free Credit Check
- So Long Landlord
- Tired of Renting?

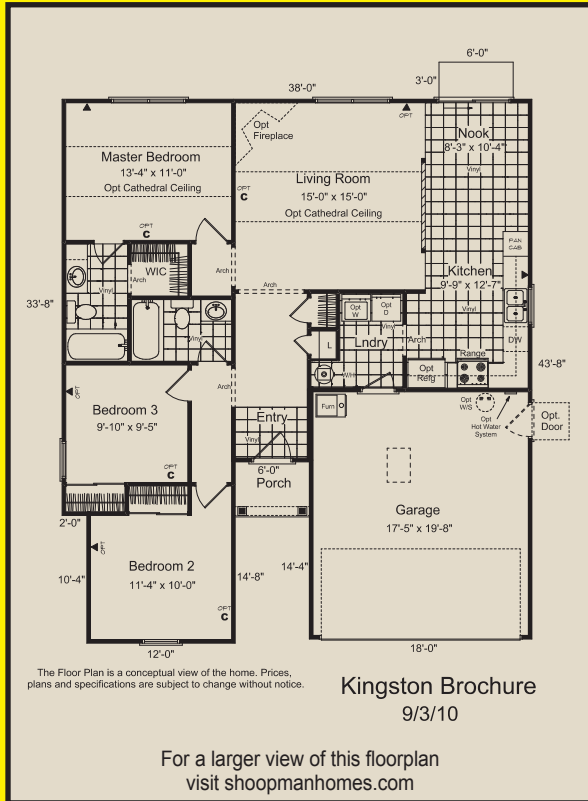

Minimum Combined Family Income Needed (before taxes) for THIS Payment				
Minimum Household Annual	Minimum Household Monthly	Minimum Household Weekly	Minimum Two Hourly Working Household Income	
\$29,900	\$2,500	\$578.00	\$7.20	\$7.20

*All Paul Shoopman Home Building Group offers, prices and sales promotions are subject to specific rules, restrictions, time periods and limited quantities; and may be changed or withdrawn without notice at any time. Ask sales consultant for details. Offer expires February 29, 2012. All referrals must be in writing and dated. They must be received prior to the date that the referred buyer contacts Paul Shoopman Home Building Group on their own, or are referred by another source. This program cannot be combined with any other program and is not retroactive. This program is subject to change and may be withdrawn at any time. Only applicable with full price offer. *Payments estimated on a FHA 30 year Fixed rate at 3.875% Principal and interest only. 4.62% APR with a 3.5% down payment. Calculations based on sale price of \$128,900.



GLENFIELD

CONVENIENT LOCATION IN HIGHLY DESIRABLE AVON.

- Glenfield features single family ranch and two-story homes that are perfect for families, couples or singles just starting out.
- This beautiful community is convenient to shopping and dining at Metropolis, convenient to I-465 & I-70 and an easy commute to Downtown Indianapolis.
- Located on North side of CR200 S., East of Dan Jones Road in Avon, Glenfield has it all wrapped up in one convenient and highly desirable location. This community is in the center of the desired Avon School District.

* All Shoopman Homes have a Diamond 2-10 Home Buyer's Warranty.

* Indianapolis' #1 referral program.

Glenfield:
1881 Collingwood Dr.
Avon, IN 46123
Phone/Fax: 317-839-6575
1-877-4-Shoopman
(1-877-474-6676)



*Payments estimated on a FHA 30 year Fixed rate at 3.875%
Principal and interest only. 4.62% APR with a 3.5% down payment.

Save as You Go Program available.



- Brand New 7,000 sq. ft. Paul Shoopman (New Home) Showroom.
- You will be amazed at the top-of-line design and features of this gorgeous showroom.
- Industry-leading facility - that features hundreds of design options and upgrades for your home.



- This unique Showroom Experience is one-of-a-kind and is now open to the Public.
- Browsing Hours are available 7 Days A Week
Mon. - Wed. 8-5 pm Saturday 8-5 pm
Thurs. - Fri. 8-7 pm Sunday 12-5 pm

new home
showroom

Located at 121st St. and Shelborne Rd.
12070 Abney Run Dr.
Zionsville, IN 46077
1-877-4-SHOOPMAN (1-877-474-6676)



We're only a click away on Mapquest



shoopmanhomes.com
Shoopman
Homes
1-877-474-6676

12070 Abney Run Dr.
Zionsville, IN 46077