

shoopmanhomes.com

Shoopman
Homes

1-877-474-6676



BIRCH RUN at WYNNE FARMS

UPSCALE LIVING IN HIGHLY DESIRABLE BROWNSBURG

Log on
for a Virtual Tour
www.shoopmanhomes.com



- 7,000 Sq. Ft.
- New Home Show Room
- Free Mortgage Qualifier
- Free Credit Check
- So Long Landlord
- Tired of Renting?



Seville

Model open 7 days a week
Call today for your showing

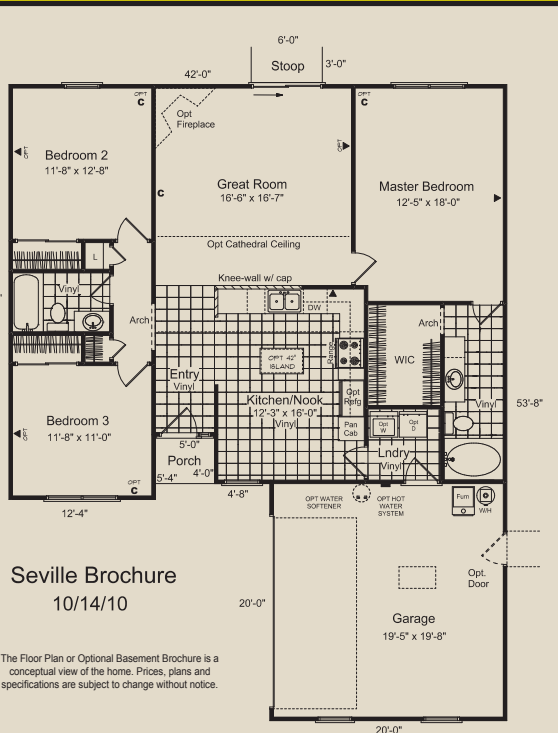

For a larger view of this floorplan
visit shoopmanhomes.com

Minimum Combined Family Income Needed (before taxes) for THIS Payment

Minimum Household Annual	Minimum Household Monthly	Minimum Household Weekly	Minimum Two Hourly Working Household Income
\$34,200	\$2,850	\$657.69	\$8.24 \$8.24

*All Paul Shoopman Home Building Group offers, prices and sales promotions are subject to specific rules, restrictions, time periods and limited quantities; and may be changed or withdrawn without notice at any time. Ask sales consultant for details. Offer expires February 29, 2012. All referrals must be in writing and dated. They must be received prior to the date that the referred buyer contacts Paul Shoopman Home Building Group on their own, or are referred by another source. This program cannot be combined with any other program and is not retroactive. This program is subject to change and may be withdrawn at any time. Only applicable with full price offer. *Payments estimated on a FHA 30 year Fixed rate at 3.875% Principal and interest only, 4.62% APR with a 3.5% down payment. Calculations based on sale price of \$143,900.



BIRCH RUN at WYNNE FARMS

UPSCALE LIVING IN HIGHLY DESIRABLE BROWNSBURG

- Single Family ranch and two-story homes from our Classic Series of homes. Homes start from \$719/mo.*, and are perfect for families of any size.
- Located on South side of CR 300 N., East of Dan Jones Road. We are just minutes from 465 and I-74, and convenient to shopping and dining in highly desirable Brownsburg.
- This community is located in the center of the desired Brownsburg school system.

* All Shoopman Homes have a Diamond 2-10 Home Buyer's Warranty.

*Indianapolis' #1 referral program.

Birch Run:
2853 Knockawuddy Dr.
Brownsburg, IN 46112
Phone/Fax: 317-209-9639
1-877-4-Shoopman
(1-877-474-6676)



*Payments estimated on a FHA 30 year Fixed rate at 3.875%
Principal and interest only. 4.62% APR with a 3.5% down payment.

Save as You Go Program available.



- Brand New 7,000 sq. ft. Paul Shoopman (New Home) Showroom.
- You will be amazed at the top-of-line design and features of this gorgeous showroom.
- Industry-leading facility - that features hundreds of design options and upgrades for your home.



newhome
showroom

Located at 121st St. and Shelborne Rd.
12070 Abney Run Dr.
Zionsville, IN 46077
1-877-4-SHOOPMAN (1-877-474-6676)



- This unique Showroom Experience is one-of-a-kind and is now open to the Public.
- Browsing Hours are available 7 Days A Week
Mon. - Wed. 8-5 pm Saturday 8-5 pm
Thurs. - Fri. 8-7 pm Sunday 12-5 pm



We're only a click away on Mapquest



12070 Abney Run Dr.
Zionsville, IN 46077